

FLOORPLAN SKETCH

Borrower: Meghan and Monte Lutterman

File No.: 16141

Property Address: 317 Crabapple Court

Case No.:

City: Steamboat Springs

State: CO

Zip: 80487

Lender: Wells Fargo Bank, N.A.

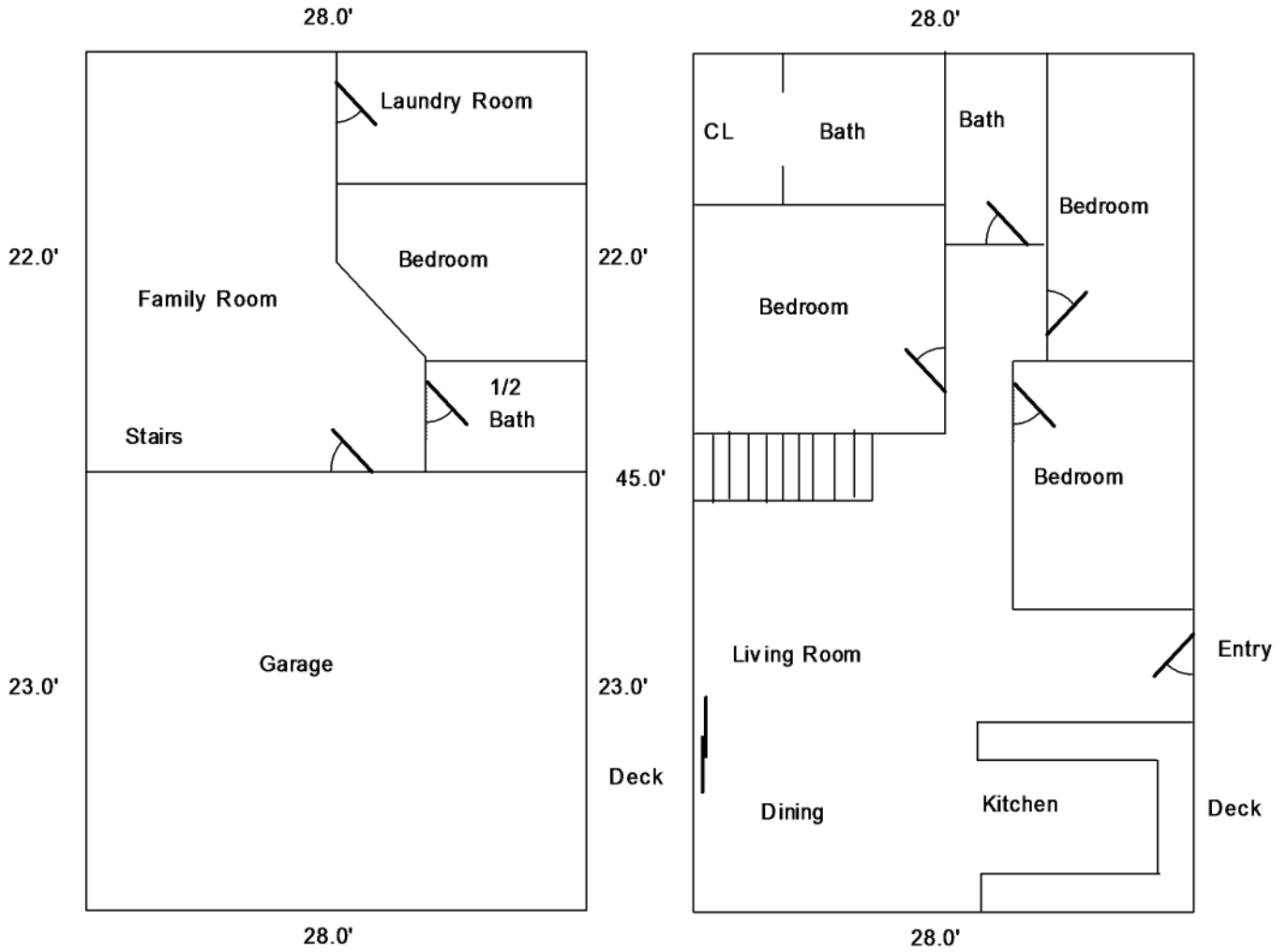

SKETCH CALCULATIONS		Perimeter	Area
<b>Living Area</b>			
Second Floor			1260.0
First Floor			616.0
<b>Total Living Area</b>			<b>1876.0</b>
<b>Garage Area</b>			
Attached Garage			644.0
<b>Total Garage Area</b>			<b>644.0</b>